

Hessian Sandbags to be filled with concrete mix ST1 and to average 450 x 225 x 100mm when filled. Laid in alternative courses of headers and stretchers.

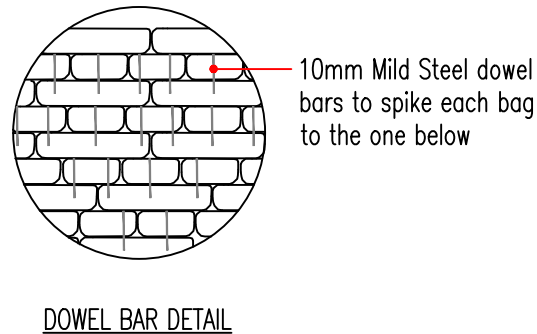
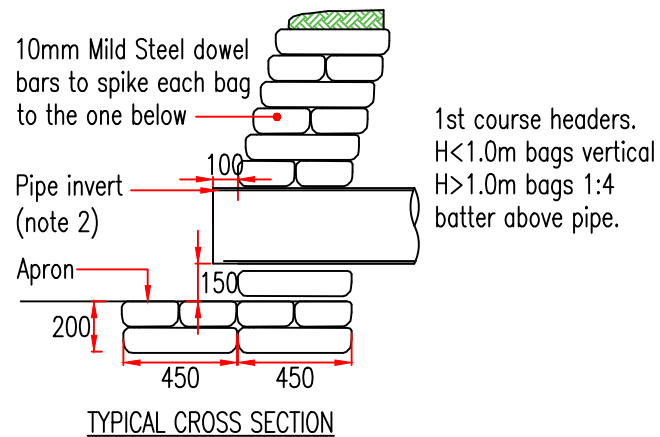
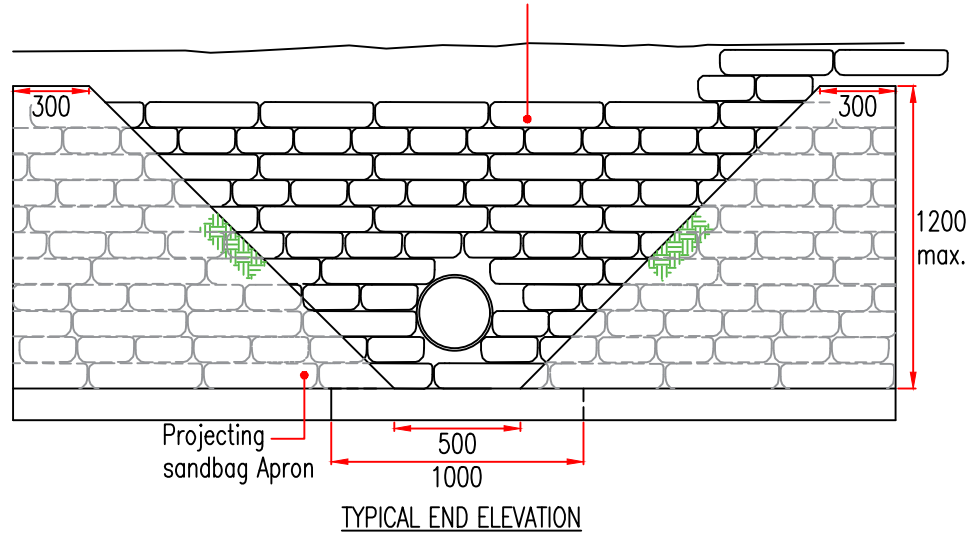

NOTES

1. The first pipe joint shall be flexible and located not more than 300mm from the back of the headwall.
2. Where the ditch outfalls into the pipe the invert of the pipe shall be level with the top of the apron.
3. Max height to be 1200mm.
4. Sandbag headwalls to be used in rural areas (urban areas by agreement).
5. Distance between the edge of headwall and footway/carriageway to be 1m minimum.
6. For pipes 450mm dia. and above, a hinge coupling grating is required.
7. Gaps to be filled with ST1 concrete.
8. When headwall required at side of a ditch, the headwall profile to match existing. Liaison with LLFA and LPA required.

REV.	DESCRIPTION	CHECKED	DATE

ORIGINATOR	INIT.	DATE	PROJECT TITLE	
RY	RY	08/2024	STANDARD CONSTRUCTION DETAILS	
CHECKER	SH	08/2024	SCALE	DATE
DESIGNER	RY	08/2024	N.T.S.	AUG. 2024
REVIEWER	TK	08/2024	DRAWING No. DM-500-12	