

Second Floor General Arrangement Plan



Refer to the detailed drawing below for full scopes of works: -

223092-CDP-ZZ-02-DR-A-3001-P02 General Arrangement Plan - Proposed Second Floor

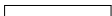

The second floor provides four further general classrooms for the school's future expansion to 1500 pupil places. Additional office/meeting rooms and staff work room are also provided for passive supervision purposes.

KEY

-  Existing Wall
-  Proposed Wall
-  Items to be demolished/removed

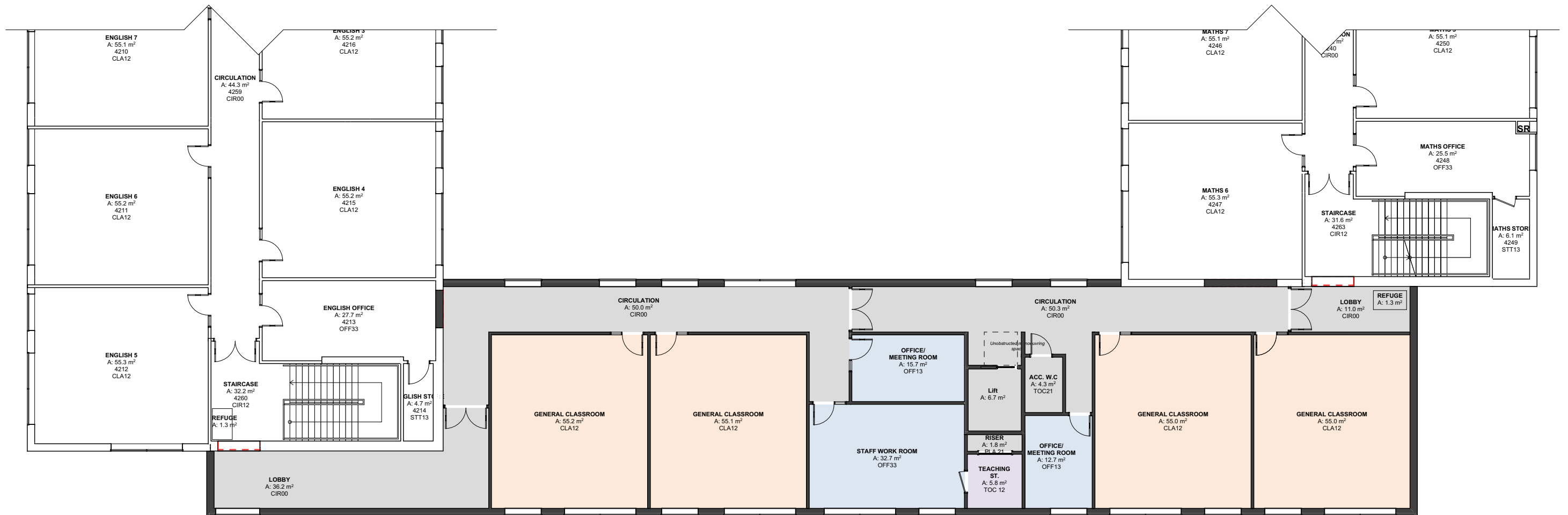

EXTENSION TO EXISTING BUILDING - SECOND FLOOR